



# DOGON | GROUP

PROPERTIES

## STATION HOUSE FLOOR PLANS



HEAD OFFICE **021 433 2580**

**dogongroup.com**

*A visionary company with decades of experience*



# DOGON | GROUP

## PROPERTIES

### COMPANY PARTICULARS

Established in 2002, Dogon Group Properties has proven to be a true real estate success story. The Dogon name has become synonymous with the proficient and effective marketing and selling of premium grade properties in Cape Town and particularly the sought-after Atlantic Seaboard. Dogon Group currently have offices in high profile positions in Sea Point and Southern Suburbs.

Dogon Group Properties prides itself on its unique and focused approach to marketing and sales, providing a comprehensive and tailored solution to ensure that sales occur at the optimum price within a compressed space of time. The company utilizes an evolved and distinctive sales force of highly adept and skilled sales agents who are selected for their extensive experience, professionalism and successful track records.

Headed by Managing Director Alexa Horne, Dogon Group has a dedicated in-house marketing department ensuring that focused and specialized marketing strategies are implemented. The powerful proprietary Dogon Group database combined with its eye-catching and prominent advertising, both in print and digital media, together with our visible network of sales offices support our strong performance on the Western Cape's Atlantic Seaboard, Southern Suburbs, Western Seaboard and surrounding areas.

DOGON GROUP PROPERTIES (PTY) LTD  
REGISTRATION NO: 2002/020365/07  
REGISTERED WITH THE PPRA - FFC NO. F110941  
ALEXA HORNE (MANAGING DIRECTOR)

P O BOX 605 SEA POINT 8060  
THE KINGS, 101 REGENT ROAD  
SEA POINT, SOUTH AFRICA  
TEL +27 21 433 2580  
FAX +27 21 433 2781

### SALES AGENTS



LESLEY RENSBURG  
**061 439 8225**  
lesley@dogongroup.com

Registered with the PPRA - Full Status Agent - FFC No. 1152541



LEAH SLEIGH  
**082 608 3388**  
leah@dogongroup.com

Registered with the PPRA - Full Status Agent - FFC No. 1198017

HEAD OFFICE **021 433 2580**

**dogongroup.com**

*A visionary company with decades of experience*

# NEXT LEVEL LIVING

24-HOUR SECURITY

WI-FI THROUGHOUT

MANAGED RENTAL SOLUTION

IN-HOUSE CONCIERGE AND CLEANING SERVICES

STATION HOUSE ON EVERY LEVEL

ICONIC SKY BAR, POOL AND RESTAURANT



PRIVATE DINING FACILITIES

MEETING PODS



SIGNATURE PICK 'N PAY SUPERMARKET



RESTAURANT, DELI AND BAR



DELIVERY LOCKERS



EXCLUSIVE RESIDENT'S ROOFTOP POOL



FITNESS CENTRE



YOGA STUDIO



BOUTIQUE HOTEL SUITES

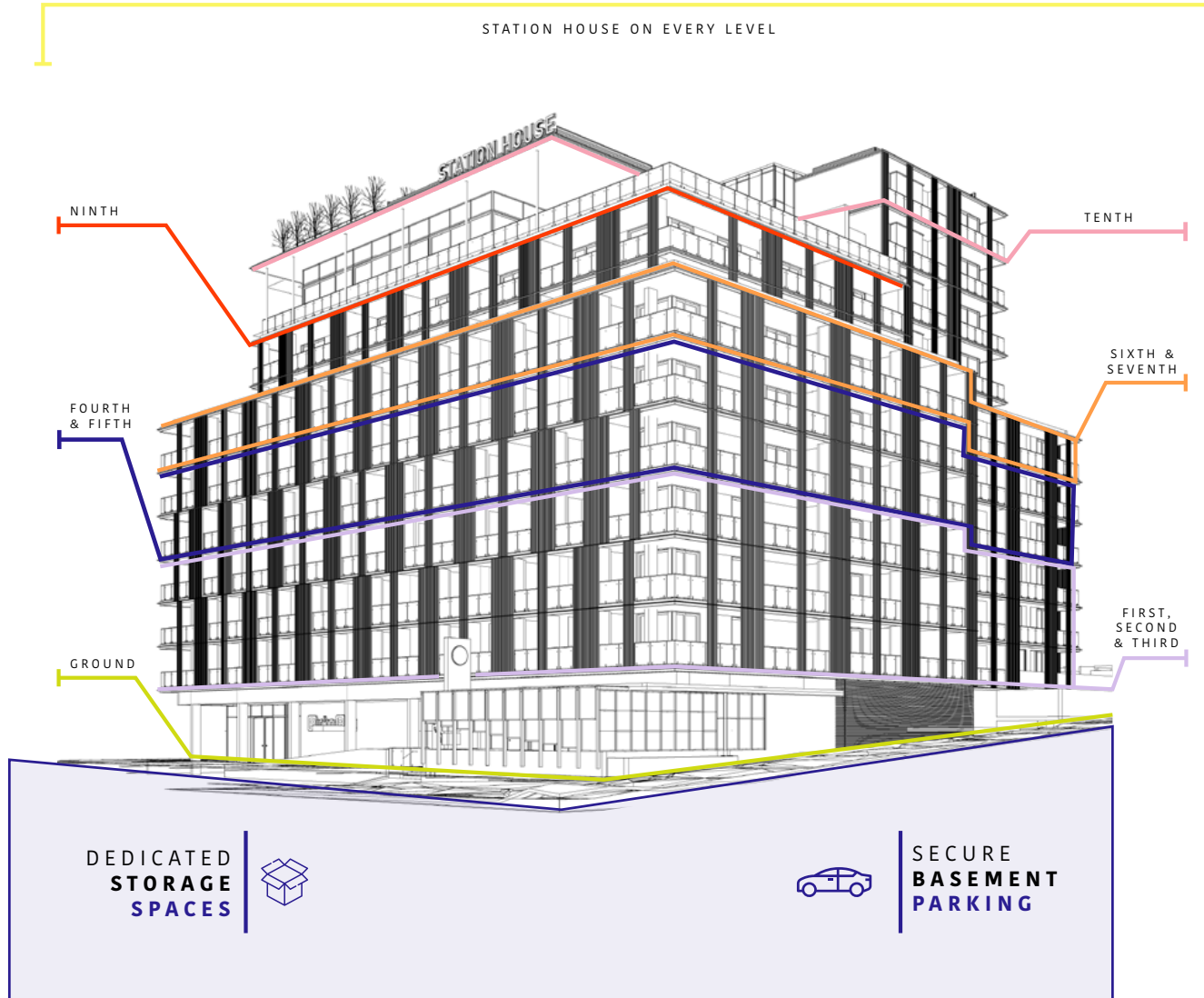

DEDICATED STORAGE SPACES



SECURE BASEMENT PARKING





BASEMENT  
5

IRWINTON ROAD

KLOOF ROAD



GORLESTON ROAD

**KEY**

- SOLD
- STORES - AVAILABLE
- STORES - HOTEL
- PARKING - RESERVED



# BASEMENT 4

IRWINTON ROAD

KLOOF ROAD

GORLESTON ROAD

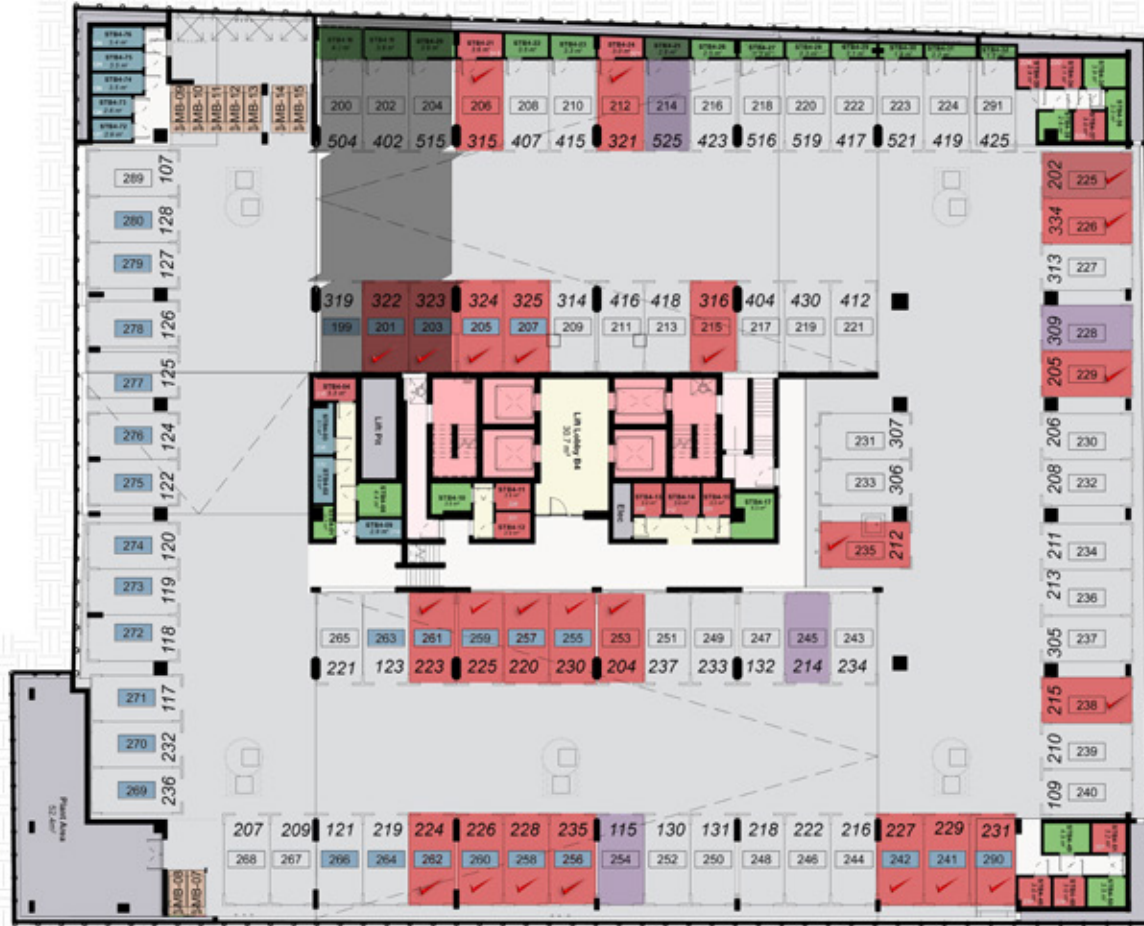

## KEY

- SOLD
- STORES - HOTEL
- STORES - AVAILABLE
- PARKING - HOTEL
- PARKING - MOTOR BIKE (9)
- PARKING - RESERVED



BASEMENT  
3



**KEY**

- SOLD
- STORES - HOTEL
- STORES AVAILABLE
- PARKING AVAILABLE (33)
- PARKING HOTEL

THESE SIZES DO NOT INCLUDE THE BALCONIES.

The depictions herein are for illustration purposes only and are subject to change without prior notice.







# BASEMENT 1



### KEY

- SOLD
- RESERVED BAYS
- PARKING - PICK N PAY (18)
- PARKING - RETAIL RESERVED (17)
- PARKING - LOADING (2)
- PARKING - DISABLED (5)
- PARKING - RESERVED /TO BE SOLD
- PARKING - MOTOR BIKE

\* REFER TO B2 PLAN





FLOOR

G



The depictions herein are for illustration purposes only and are subject to change without prior notice.





## UNIT TYPES

- TYPE 1 | 1 BED | 39,4m<sup>2</sup>
- TYPE 2 | STUDIO | 34,8m<sup>2</sup>
- TYPE 3 | STUDIO & 1 BED | 37,8m<sup>2</sup>
- TYPE 4 | STUDIO | 27,0m<sup>2</sup>
- TYPE 5 | STUDIO | 24,4m<sup>2</sup>
- TYPE 6 | STUDIO | 31,0m<sup>2</sup>
- TYPE 7 | STUDIO | 26,3m<sup>2</sup>
- TYPE 8 | 1 BED | 48,7m<sup>2</sup>
- TYPE 9 | 1 BED | 42,8m<sup>2</sup>
- TYPE 10 | 2 BED | 92,6m<sup>2</sup>
- TYPE 11 | 1 BED | 38,1m<sup>2</sup>
- TYPE 12 | 1 BED | 47,6m<sup>2</sup>
- TYPE 13 | 2 BED | 81,1m<sup>2</sup>
- TYPE 14 | 2 BED | 63,5m<sup>2</sup>
- TYPE 16 | 3 BED | 167,7m<sup>2</sup>
- TYPE 17 | 3 BED | 167,0m<sup>2</sup>
- TYPE 18 | 2 BED | 102,5m<sup>2</sup>
- TYPE 19 | 2 BED | 75,8m<sup>2</sup>

GROUND  
MEZZANINE FLOOR

KLOOF ROAD

GORLESTON ROAD

IRWINTON ROAD  
P&P TRUCK LOADING

PICK 'N PAY  
BACK OF HOUSE

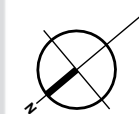

## UNIT TYPES

- TYPE 1 | 1 BED | 39,1m<sup>2</sup>
- TYPE 2 | STUDIO | 34,5m<sup>2</sup>
- TYPE 3 | STUDIO & 1 BED | 37,2m<sup>2</sup>
- TYPE 4 | STUDIO | 26,8m<sup>2</sup>
- TYPE 5 | STUDIO | 24,0m<sup>2</sup>
- TYPE 6 | STUDIO | 30,5m<sup>2</sup>
- TYPE 7 | STUDIO | 26,0m<sup>2</sup>
- TYPE 8 | 1 BED | 47,9m<sup>2</sup>
- TYPE 9 | 1 BED | 42,2m<sup>2</sup>
- TYPE 10 | 2 BED | 90,8m<sup>2</sup>
- TYPE 11 | 1 BED | 37,6m<sup>2</sup>
- TYPE 12 | 1 BED | 45,7m<sup>2</sup>
- TYPE 13 | 2 BED | 78,6m<sup>2</sup>
- TYPE 14 | 2 BED | 62,1m<sup>2</sup>
- TYPE 15 | 2 BED | 108,5m<sup>2</sup>
- TYPE 16 | 3 BED | 167,7m<sup>2</sup>
- TYPE 17 | 3 BED | 167,0m<sup>2</sup>
- TYPE 18 | 3 BED | 133,0m<sup>2</sup>
- TYPE 19 | 2 BED | 74,6m<sup>2</sup>
- TYPE 20 | 2 BED | 68,9m<sup>2</sup>
- TYPE 21 | 3 BED | 102,8m<sup>2</sup>
- TYPE 22 | 2 BED | 77,5m<sup>2</sup>
- TYPE 23 | 1 BED | 51,7m<sup>2</sup>

IRWINTON ROAD

GORLESTON ROAD

KLOOF ROAD

PET PARK

OUTDOOR KINETIC GYM

OUTDOOR BRAAI AREA

RESIDENTS LOUNGE

UNIT 104

UNIT 105

UNIT 106

UNIT 107

UNIT 108

UNIT 109

UNIT 103

UNIT 102

UNIT 101

UNIT 132

UNIT 131

UNIT 130

UNIT 129

UNIT 128

UNIT 127

UNIT 126

UNIT 125

UNIT 124

UNIT 123

UNIT 122

UNIT 121

UNIT 120

UNIT 119

UNIT 118

UNIT 117

UNIT 116

UNIT 110

UNIT 111

UNIT 112

UNIT 113

UNIT 114

UNIT 115









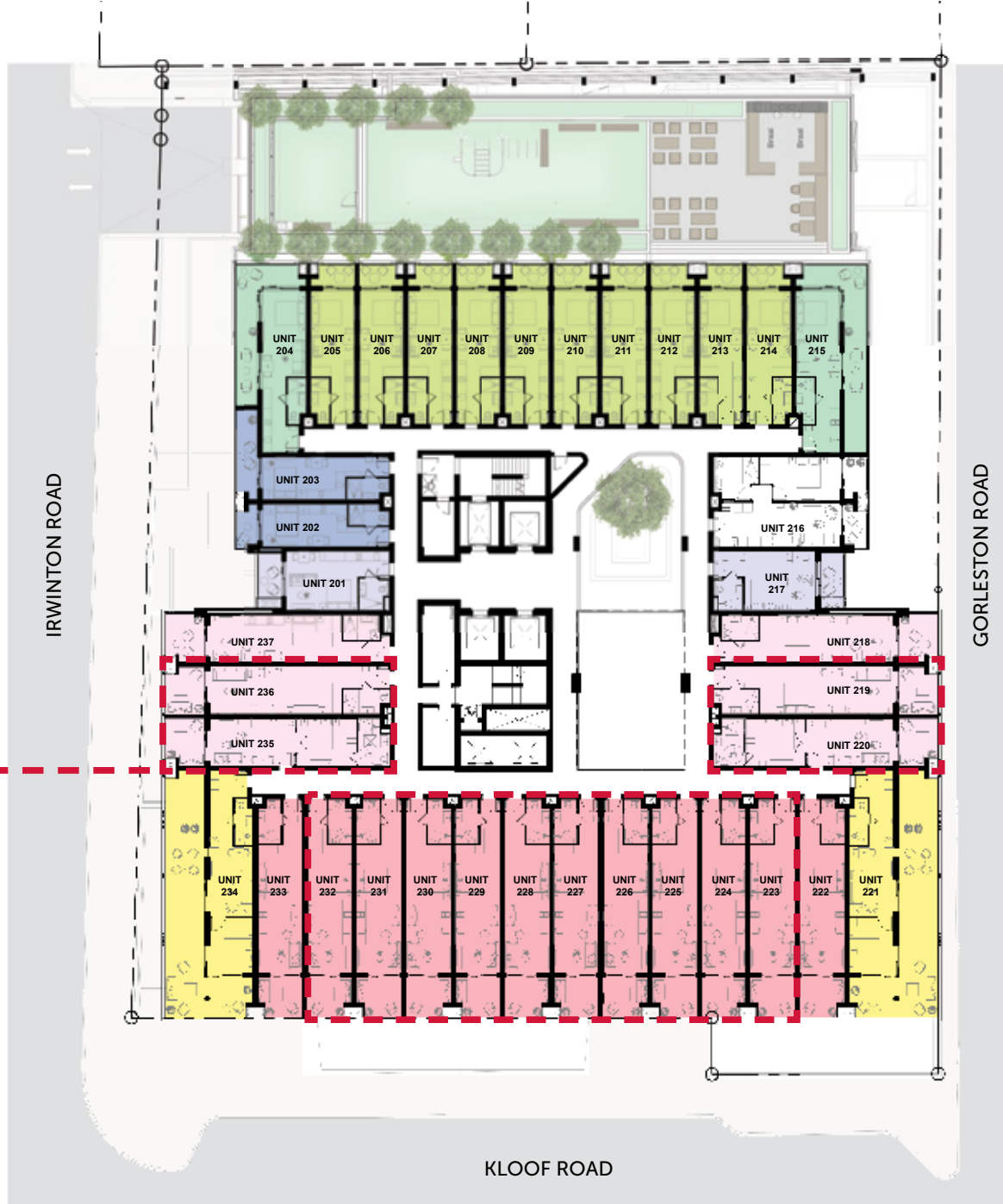



FLOOR

2

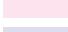

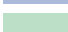
**BOUTIQUE  
HOTEL**

**UNIT TYPE KEY**

	TYPE 1	1 BED	39.4M <sup>2</sup>
	TYPE 2	STUDIO	34.8M <sup>2</sup>
	TYPE 3	STUDIO & 1 BED	37.8M <sup>2</sup>
	TYPE 4	STUDIO	27.0M <sup>2</sup>
	TYPE 5	STUDIO	24.4M <sup>2</sup>
	TYPE 6	STUDIO	31.0M <sup>2</sup>
	TYPE 7	STUDIO	26.3M <sup>2</sup>
	TYPE 8	1 BED	48.7M <sup>2</sup>

KLOOF ROAD

**THESE SIZES DO NOT INCLUDE THE BALCONIES.**

The depictions herein are for illustration purposes only and are subject to change without prior notice.



# UNIT TYPES

- TYPE 1 | 1 BED | 39,1m<sup>2</sup>
- TYPE 2 | STUDIO | 34,5m<sup>2</sup>
- TYPE 3 | STUDIO & 1 BED | 37,2m<sup>2</sup>
- TYPE 4 | STUDIO | 26,8m<sup>2</sup>
- TYPE 5 | STUDIO | 24,0m<sup>2</sup>
- TYPE 6 | STUDIO | 30,5m<sup>2</sup>
- TYPE 7 | STUDIO | 26,0m<sup>2</sup>
- TYPE 8 | 1 BED | 47,9m<sup>2</sup>
- TYPE 9 | 1 BED | 42,2m<sup>2</sup>
- TYPE 10 | 2 BED | 90,8m<sup>2</sup>
- TYPE 11 | 1 BED | 37,6m<sup>2</sup>
- TYPE 12 | 1 BED | 45,7m<sup>2</sup>
- TYPE 13 | 2 BED | 78,6m<sup>2</sup>
- TYPE 14 | 2 BED | 62,1m<sup>2</sup>
- TYPE 15 | 2 BED | 108,5m<sup>2</sup>
- TYPE 16 | 3 BED | 218,3m<sup>2</sup>
- TYPE 17 | 3 BED | 245,8m<sup>2</sup>
- TYPE 18 | 3 BED | 133,0m<sup>2</sup>
- TYPE 19 | 2 BED | 74,6m<sup>2</sup>
- TYPE 20 | 2 BED | 68,9m<sup>2</sup>
- TYPE 21 | 3 BED | 102,8m<sup>2</sup>
- TYPE 22 | 2 BED | 77,5m<sup>2</sup>
- TYPE 23 | 1 BED | 51,7m<sup>2</sup>
- TYPE 24 | 1 BED | 37,5m<sup>2</sup>



THIRD FLOOR

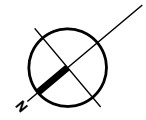

FLOOR

4



### UNIT TYPE KEY

	TYPE 3	STUDIO & 1 BED	37.2M <sup>2</sup>
	TYPE 4	STUDIO	26.8M <sup>2</sup>
	TYPE 7	STUDIO	26.0M <sup>2</sup>
	TYPE 8	1 BED	48.9M <sup>2</sup>
	TYPE 14	2 BED	62.1M <sup>2</sup>
	TYPE 19	2 BED	74.6M <sup>2</sup>
	TYPE 20	2 BED	68.9M <sup>2</sup>
	TYPE 22	2 BED	77.5M <sup>2</sup>

THESE SIZES DO NOT INCLUDE THE BALCONIES.

The depictions herein are for illustration purposes only and are subject to change without prior notice.













FLOOR

5

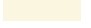

### UNIT TYPE KEY

	TYPE 3	STUDIO & 1 BED	37.2M <sup>2</sup>
	TYPE 4	STUDIO	26.8M <sup>2</sup>
	TYPE 7	STUDIO	26.0M <sup>2</sup>
	TYPE 8	1 BED	47.9M <sup>2</sup>
	TYPE 14	2 BED	62.1M <sup>2</sup>
	TYPE 19	2 BED	74.6M <sup>2</sup>
	TYPE 20	2 BED	68.9M <sup>2</sup>
	TYPE 22	2 BED	77.5M <sup>2</sup>
	TYPE 23	1 BED	51.7M <sup>2</sup>

**THESE SIZES DO NOT INCLUDE THE BALCONIES.**

The depictions herein are for illustration purposes only and are subject to change without prior notice.



FLOOR

6



### UNIT TYPE KEY

	TYPE 3	STUDIO & 1 BED	37.2M <sup>2</sup>
	TYPE 4	STUDIO	26.8M <sup>2</sup>
	TYPE 7	STUDIO	26.0M <sup>2</sup>
	TYPE 8	1 BED	47.9M <sup>2</sup>
	TYPE 14	2 BED	62.1M <sup>2</sup>
	TYPE 19	2 BED	74.6M <sup>2</sup>
	TYPE 20	1 BED	68.9M <sup>2</sup>
	TYPE 21	3 BED	102.8M <sup>2</sup>
	TYPE 22	2 BED	77.5M <sup>2</sup>

**THESE SIZES DO NOT INCLUDE THE BALCONIES.**

The depictions herein are for illustration purposes only and are subject to change without prior notice.



# UNIT TYPES

- TYPE 1 | 1 BED | 39,1m<sup>2</sup>
- TYPE 2 | STUDIO | 34,5m<sup>2</sup>
- TYPE 3 | STUDIO & 1 BED | 37,2m<sup>2</sup>
- TYPE 4 | STUDIO | 26,8m<sup>2</sup>
- TYPE 5 | STUDIO | 24,0m<sup>2</sup>
- TYPE 6 | STUDIO | 30,5m<sup>2</sup>
- TYPE 7 | STUDIO | 26,0m<sup>2</sup>
- TYPE 8 | 1 BED | 47,9m<sup>2</sup>
- TYPE 9 | 1 BED | 42,2m<sup>2</sup>
- TYPE 10 | 2 BED | 90,8m<sup>2</sup>
- TYPE 11 | 1 BED | 37,6m<sup>2</sup>
- TYPE 12 | 1 BED | 45,7m<sup>2</sup>
- TYPE 13 | 2 BED | 78,6m<sup>2</sup>
- TYPE 14 | 2 BED | 62,1m<sup>2</sup>
- TYPE 15 | 2 BED | 108,5m<sup>2</sup>
- TYPE 16 | 3 BED | 218,3m<sup>2</sup>
- TYPE 17 | 3 BED | 245,8m<sup>2</sup>
- TYPE 18 | 3 BED | 133,0m<sup>2</sup>
- TYPE 19 | 2 BED | 74,6m<sup>2</sup>
- TYPE 20 | 2 BED | 68,9m<sup>2</sup>
- TYPE 21 | 3 BED | 102,8m<sup>2</sup>
- TYPE 22 | 2 BED | 77,5m<sup>2</sup>
- TYPE 23 | 1 BED | 51,7m<sup>2</sup>
- TYPE 24 | 1 BED | 37,5m<sup>2</sup>



SEVENTH FLOOR

KLOOF ROAD

GORLESTON ROAD

IRWINTON ROAD

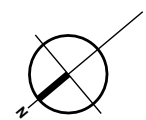







FLOOR

8



UNIT TYPE KEY

	TYPE 9	1 BED	42.2M <sup>2</sup>
	TYPE 11	1 BED	37.6M <sup>2</sup>
	TYPE 12	1 BED	45.7M <sup>2</sup>
	TYPE 13	2 BED	78.6M <sup>2</sup>
	TYPE 18	2 BED	133.0M <sup>2</sup>

THESE SIZES DO NOT INCLUDE THE BALCONIES.

The depictions herein are for illustration purposes only and are subject to change without prior notice.





**UNIT TYPES**



- TYPE 1 | 1 BED | 39,1m<sup>2</sup>
- TYPE 2 | STUDIO | 34,5m<sup>2</sup>
- TYPE 3 | STUDIO & 1 BED | 37,2m<sup>2</sup>
- TYPE 4 | STUDIO | 26,8m<sup>2</sup>
- TYPE 5 | STUDIO | 24,0m<sup>2</sup>
- TYPE 6 | STUDIO | 30,5m<sup>2</sup>
- TYPE 7 | STUDIO | 26,0m<sup>2</sup>
- TYPE 8 | 1 BED | 47,9m<sup>2</sup>
- TYPE 9 | 1 BED | 42,2m<sup>2</sup>
- TYPE 10 | 2 BED | 90,8m<sup>2</sup>
- TYPE 11 | 1 BED | 37,6m<sup>2</sup>
- TYPE 12 | 1 BED | 45,7m<sup>2</sup>
- TYPE 13 | 2 BED | 78,6m<sup>2</sup>
- TYPE 14 | 2 BED | 62,1m<sup>2</sup>
- TYPE 15 | 2 BED | 108,5m<sup>2</sup>
- TYPE 16 | 3 BED | 218,3m<sup>2</sup>
- TYPE 17 | 3 BED | 245,8m<sup>2</sup>
- TYPE 18 | 3 BED | 133,0m<sup>2</sup>
- TYPE 19 | 2 BED | 74,6m<sup>2</sup>
- TYPE 20 | 2 BED | 68,9m<sup>2</sup>
- TYPE 21 | 3 BED | 102,8m<sup>2</sup>
- TYPE 22 | 2 BED | 77,5m<sup>2</sup>
- TYPE 23 | 1 BED | 51,7m<sup>2</sup>
- TYPE 24 | 1 BED | 37,5m<sup>2</sup>



FLOOR  
**10**



**UNIT TYPE KEY**

	TYPE 11	1 BED	37.6M <sup>2</sup>
	UNIT 1101	INTERNAL: 125M <sup>2</sup>	EXTERNAL: 65M <sup>2</sup>
	UNIT 1102	INTERNAL: 158M <sup>2</sup>	EXTERNAL: 76M <sup>2</sup>

**THESE SIZES DO NOT INCLUDE THE BALCONIES.**

The depictions herein are for illustration purposes only and are subject to change without prior notice.





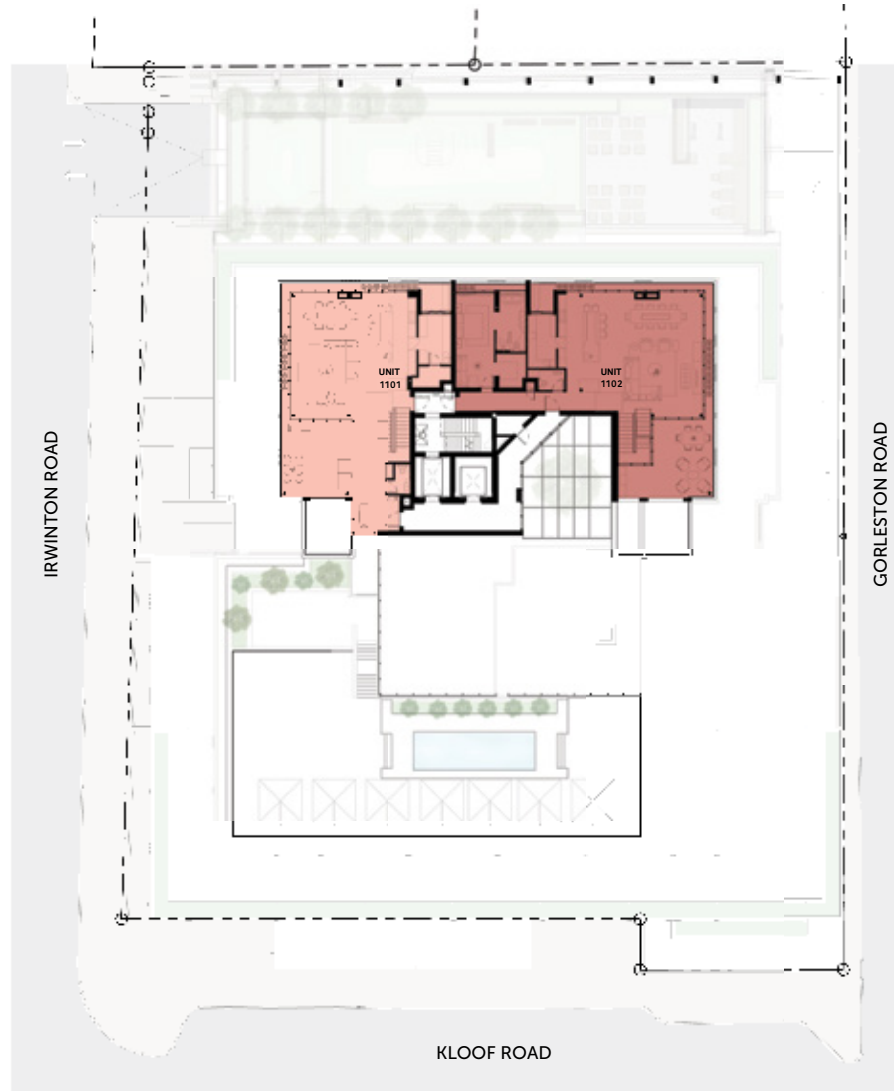

FLOOR

11



11TH FLOOR

### UNIT TYPE KEY

	UNIT 1101	INTERNAL: 125M <sup>2</sup>	EXTERNAL: 65M <sup>2</sup>
	UNIT 1102	INTERNAL: 158M <sup>2</sup>	EXTERNAL: 76M <sup>2</sup>

**THESE SIZES DO NOT INCLUDE THE BALCONIES.**

The depictions herein are for illustration purposes only and are subject to change without prior notice.

